

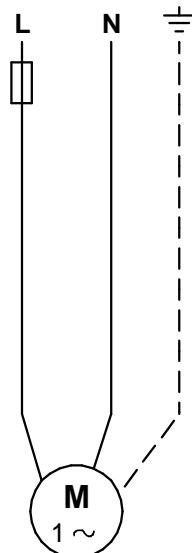

Position	Qty.	Description	Single Price
	1	<p>UP 15-14 BUT 80</p>  <p>Note! Product picture may differ from actual product</p> <p>Product No.: 96433886</p> <p>The pump is equipped with a spherical motor. In contradistinction to the conventional canned-rotor motors, the spherical motor does not have a rotating bearing shaft. The stator transfers the magnetic field to the rotor in the water-conducting part of the pump. The pump is only suitable for pressurised hot water systems.</p> <p>The water-conducting part of the pump is hermetically separated from the stator with a stainless steel spherical separator.</p> <p>The built-in timer enables the pump to start and stop automatically at set intervals of minimum 20 minutes.</p> <p>The built-in thermostat can be set to stop the pump at a preset liquid temperature.</p> <p>The pump is characterized by:</p> <ul style="list-style-type: none"> * Self-adjusting, gimbal-mounted rotor bearing lubricated by the pumped liquid. * High-quality bearing material. * The motor can be separated from the pump housing, enabling easy maintenance and replacement. * Corrosion-resistant impeller, Stainless steel, EPDM, PPO, PTFE, Graphit. * Brass pump housing. <p>The motor is a single-phase motor. It does not require external motor protection.</p> <p>Liquid: Liquid temperature range: 2 .. 95 °C Density: 1000 kg/m³</p> <p>Technical:</p> <p>Actual calculated flow: 0.307 m³/h Resulting head of the pump: 1.02 m TF class: 95 Maximum operating pressure: 10 bar Approvals on nameplate: VDE,BSI,B,CE</p> <p>Materials:</p>	Price on request

Position	Qty.	Description	Single Price
		<p>Pump housing: Brass MS 68</p> <p>Impeller: Stainless steel, EPDM, PPO, PTFE, Graphit</p> <p>Installation:</p> <p>Maximum operating pressure: 10 bar</p> <p>Pipe connection: Rp 1/2</p> <p>Port-to-port length: 80 mm</p> <p>Electrical data:</p> <p>Max. power input: 25 W</p> <p>Mains frequency: 50 Hz</p> <p>Rated voltage: 1 x 230 V</p> <p>Current in speed 3: 0.11 A</p> <p>Capacitor size - run: 0.6 muF</p> <p>Enclosure class (IEC 34-5): 42</p> <p>Insulation class (IEC 85): F</p> <p>Others:</p> <p>Net weight: 1.16 kg</p> <p>Gross weight: 1.32 kg</p> <p>Shipping volume: 0.003 m3</p>	

Description	Value
Product name:	UP 15-14 BUT 80
Product No:	96433886
EAN number:	5700393609570
Technical:	
Speed no:	1
Actual calculated flow:	0.307 m³/h
Resulting head of the pump:	1.02 m
Head max:	14 dm
TF class:	95
Maximum operating pressure:	10 bar
Approvals on nameplate:	VDE,BSI,B,CE
Materials:	
Pump housing:	Brass MS 68
Impeller:	Stainless steel, EPDM, PPO, PTFE, Graphit
Installation:	
Maximum operating pressure:	10 bar
Pipe connection:	Rp 1/2
Port-to-port length:	80 mm
Liquid:	
Liquid temperature range:	2 .. 95 °C
Density:	1000 kg/m³
Electrical data:	
Max. power input:	25 W
Mains frequency:	50 Hz
Rated voltage:	1 x 230 V
Current in speed 3:	0.11 A
Capacitor size - run:	0.6 µF
Enclosure class (IEC 34-5):	42
Insulation class (IEC 85):	F
Motor protec:	NONE
Thermal protec:	Impedance protected
Controls:	
Thermostat:	built in for stop of the pump at preset liquid temperature
Range of Thermost. temp.:	35 .. 65 °C
Time switch:	internal on/off time switch included
Others:	
Net weight:	1.16 kg
Gross weight:	1.32 kg
Shipping volume:	0.003 m³

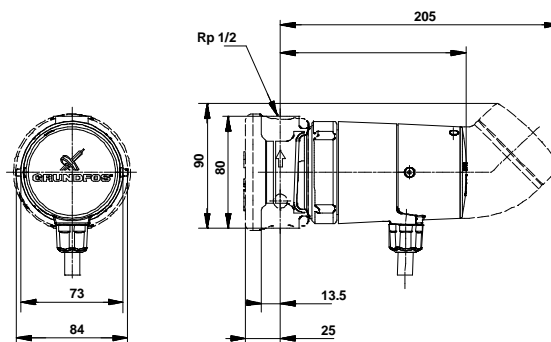
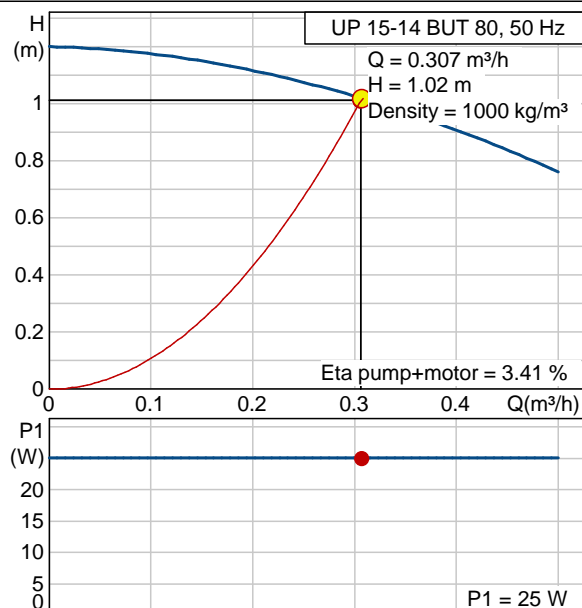

96433886 UP 15-14 BUT 80 50 Hz

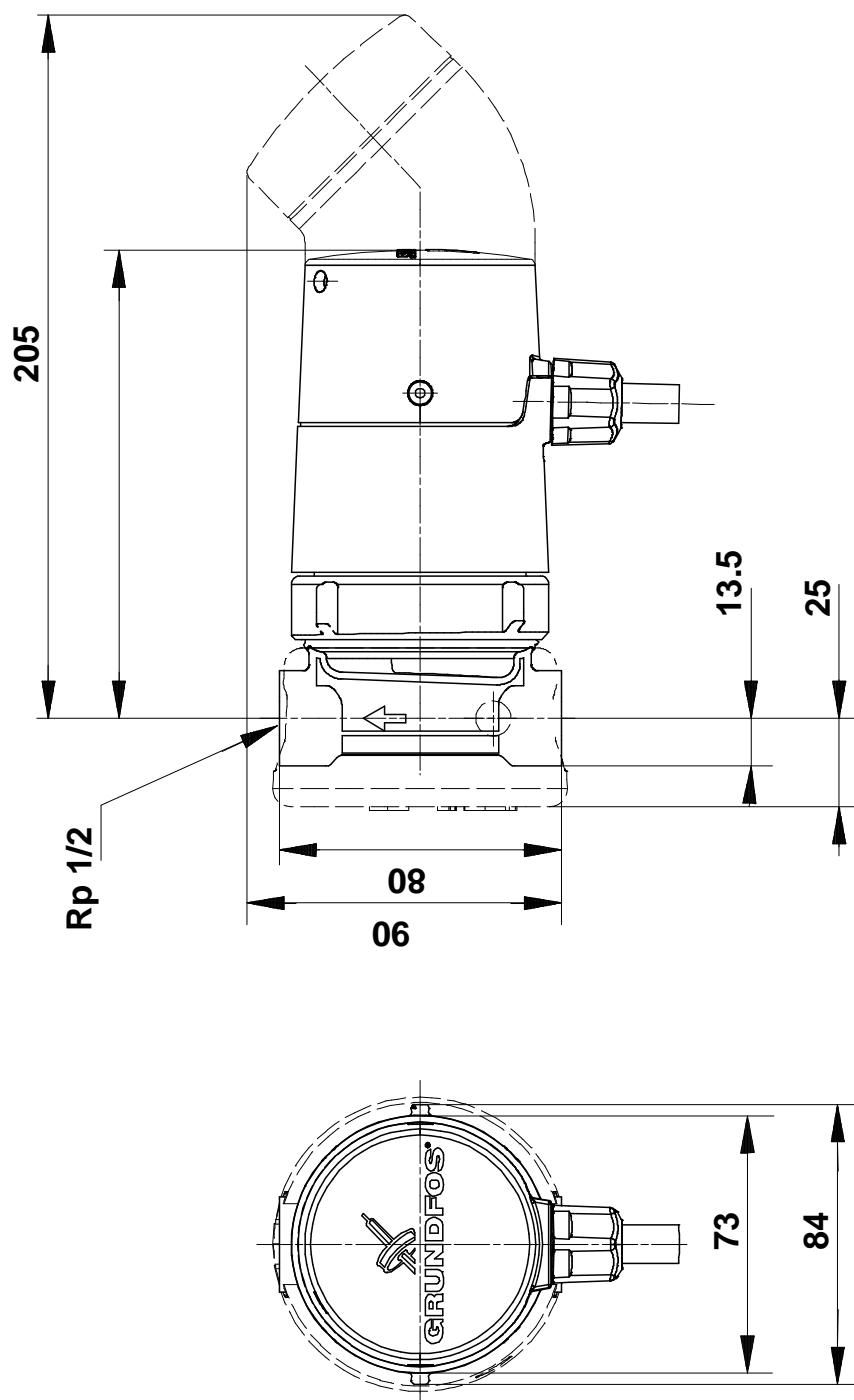

Note! All units are in [mm] unless others are stated.

Disclaimer: This simplified dimensional drawing does not show all details.



96433886 UP 15-14 BUT 80 50 Hz

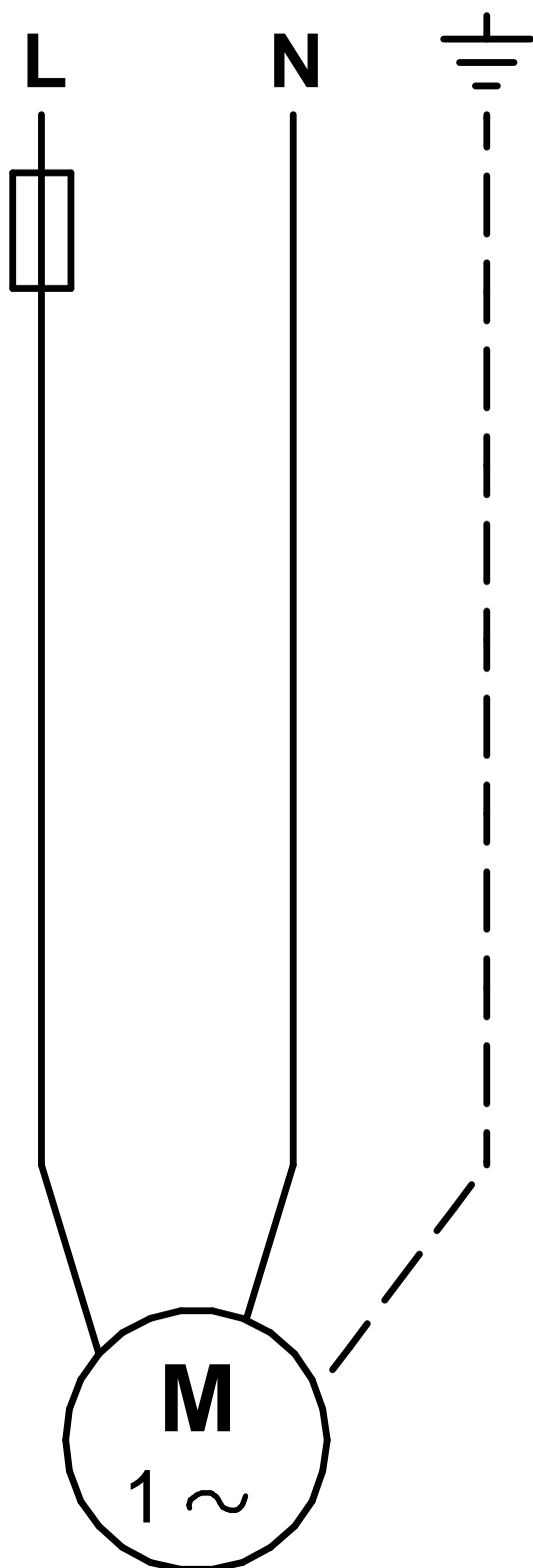

Note! All units are in [mm] unless others are stated.